

FORMULA 1 VTB RUSSIAN GRAND PRIX

DIRECTIONS

Sochi Autodrom is located approximately 10 km from Sochi International Airport. The Paddock Club parking is located in the close proximity to the Sochi Autodrom.

To get to the Formula One Paddock Club™ parking from Sochi center, Matsesta, Khosta, Kudepsta take the M-27 in the direction of the Olympic Park, then turn right in the direction of Lenin street and follow the respective signage to get to the parking. From Adler center take Lenin Street, then Kaspiyskaya Street direction Olympic Park, then follow the signage indicating the location of the Formula One Paddock Club™ parking.

From Krasnaya Polyana either the A-148 or the new combined road can be used in the direction of the Olympic Park. When approaching the Olympic Park, follow the signs with the parking indications. From all areas and hotels located to the east of the Sochi Autodrom (Azimut, Alexandrovsky Sad, Barkhatnye Sezony, Russky Dom, Radisson Blu Paradise Resort & Spa, etc.) take Staroobrjacheskaya street to get to the Olympic Park, then pass the Sochi Autodrom and all Olympic venues keeping them on your right hand side and follow the signs with the Formula One Paddock Club™ parking indication. Once your vehicle is parked at the parking, please pass through the security screening and take a shuttle van to get to the Formula One Paddock Club™ or to the F1 Village™ and Concert area.

Please note:

- The parking is open from 7 AM to 7 PM during the 3 days of the event.
- Vehicles transporting more than 10 persons and longer than 5.7 m are considered to be a coach.
- Motorbikes require a Formula One Paddock Club™ parking sticker.
- Please bear in mind the heavy traffic during the race weekend.

All parking stickers are non-transferable and should be displayed at all times.

Please use following stickers per day:

Friday: GREEN, Saturday: ORANGE, Sunday: PINK

SUPPORT RACE PADDOCK AND F1® VILLAGE

With your F1® ticket you have access to the Support Race Paddock throughout the F1® race weekend. Please take the shuttle van marked Support Race Paddock from the front entrance of the Formula One Paddock Club™ should you wish to visit the Support Race Paddock.

If you would like to pay a visit to the F1 Village™ please take a shuttle van marked F1 Village™ from the Formula One Paddock Club™ entrance.

Grand Prix Facts:

First Grand Prix: 2014

Circuit Length: 5.848 km

Lap Record: 1:40.071 (Sebastian Vettel, 2015)

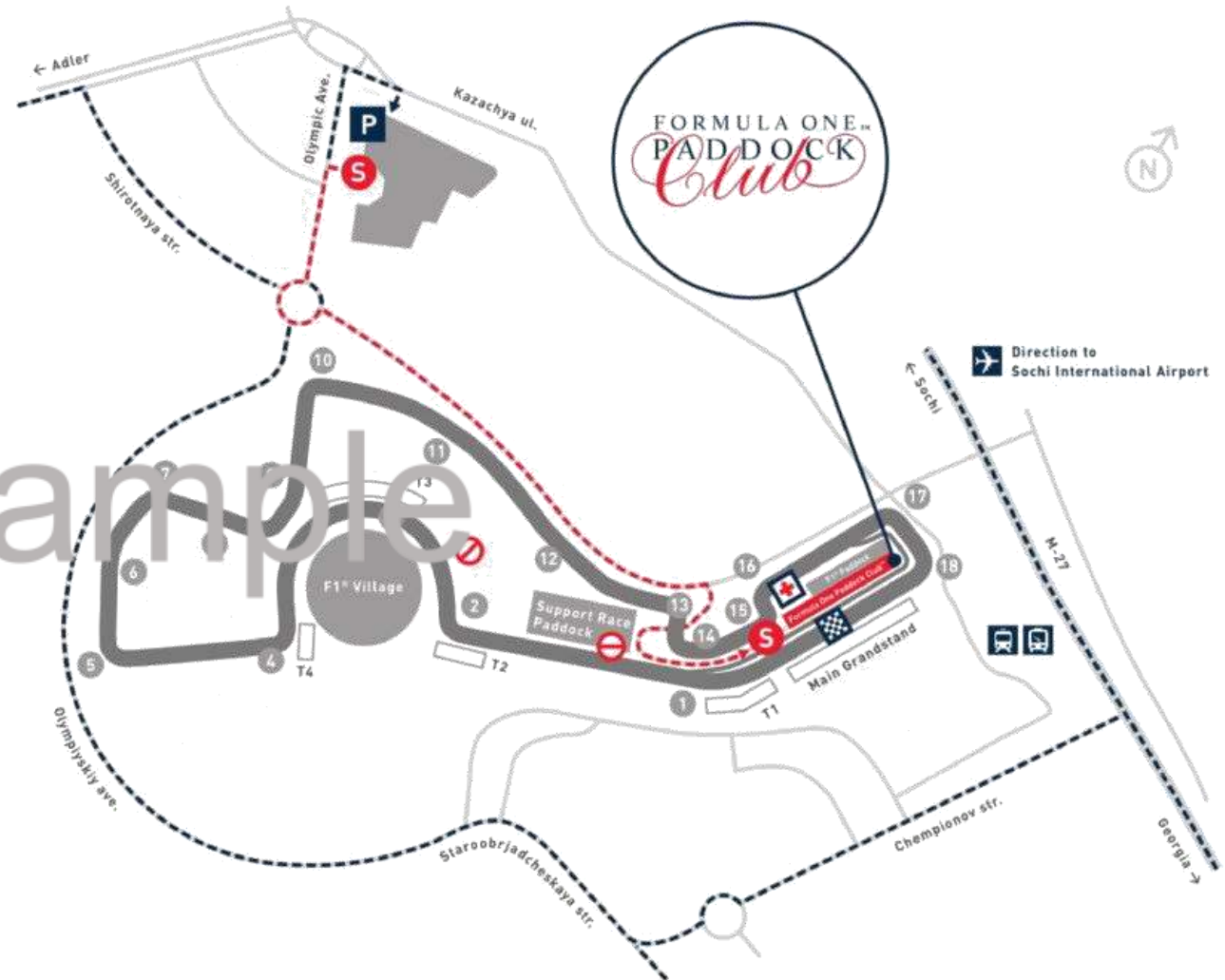

- | | | | |
|----------|-------------------------------|----------|-----------------------------|
| P | Parking Area | 1 | Turn Number (1 - 18) |
| S | Shuttle Service Pick Up-Point | + | Medical Centre |
| ⊖ | Shuttle Stop | ✈ | Sochi International Airport |
| ■ | Hospitality Venue | 🚉 | Train Station |
| 🏁 | Start / Finish | 🚌 | Bus Station |